

<Top jamb of frame>

STANDARD/PRESET IN BACK CHECK DOOR CLOSER

Standard installation template for LEFT hand doors mounted on door on pull side>

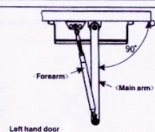
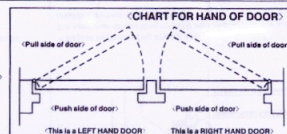

Left hand door

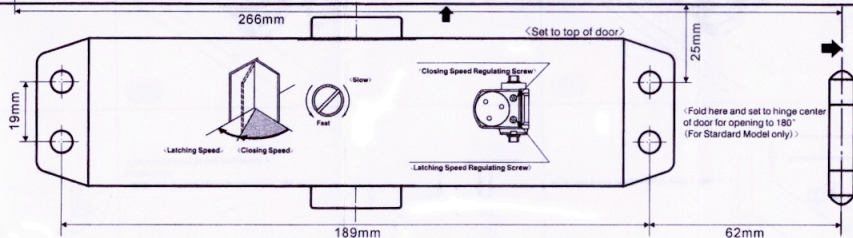

1

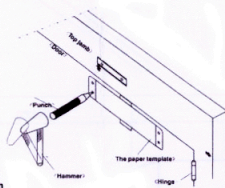

< Put the paper template tight with the door and door frame, (the side line that the arrowhead aims at the door). Mark on the door and door frame. >

2

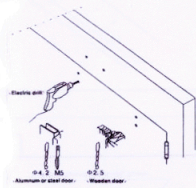

<Drill $\phi 4.2$ hole against the mark. Tap M5 screw hole (For wood door is not required).>

3

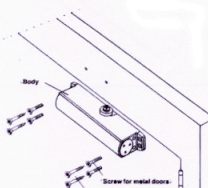

<Fix the body on the door with 4 screw. >

4

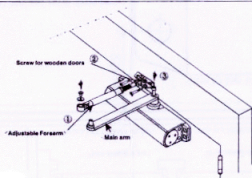

<1. Loose the screw of adjustable forearm.
2. Fix the adjustable forearm on the door frame with two screw.
3. Fix the main arm on the body with one screw. >

5

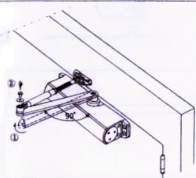

<1. Turn the main arm and make the main arm with the body as 90.
2. Tight the screw of adjustable forearm. >

6

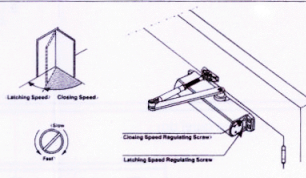

<Adjust door closing speed and latching speed : the user can according to their needed adjust the screw closing and latching speed individually. >

